

새로운 e-티켓 서비스에 대한 소개

① 상위 메뉴

다국어 선택 (영어, 중국어 간체, 중국어 번체, 한국어 선택 가능)

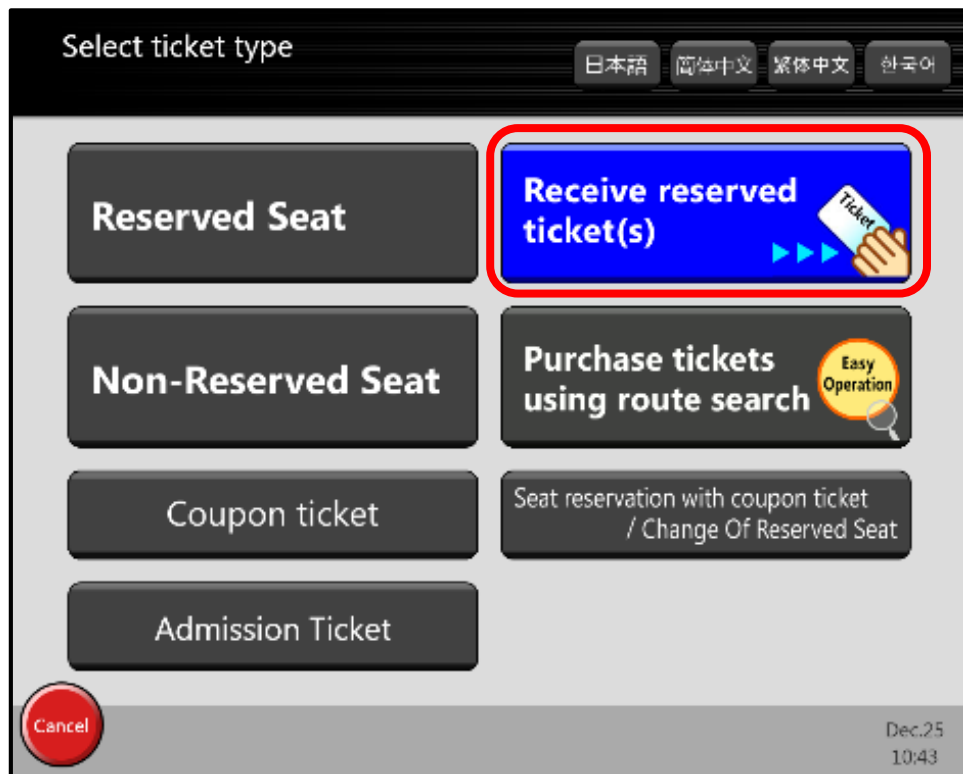
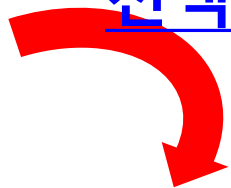

② 하위 메뉴

"재팬 패스로 교환하기" 선택



③ QR 코드 스캔

스마트폰으로도 가능

Scan your QR code

Inquiry will be made based on the QR code information

If forgot your QR code

Enter service order number

Cancel

Jan.10
11:10

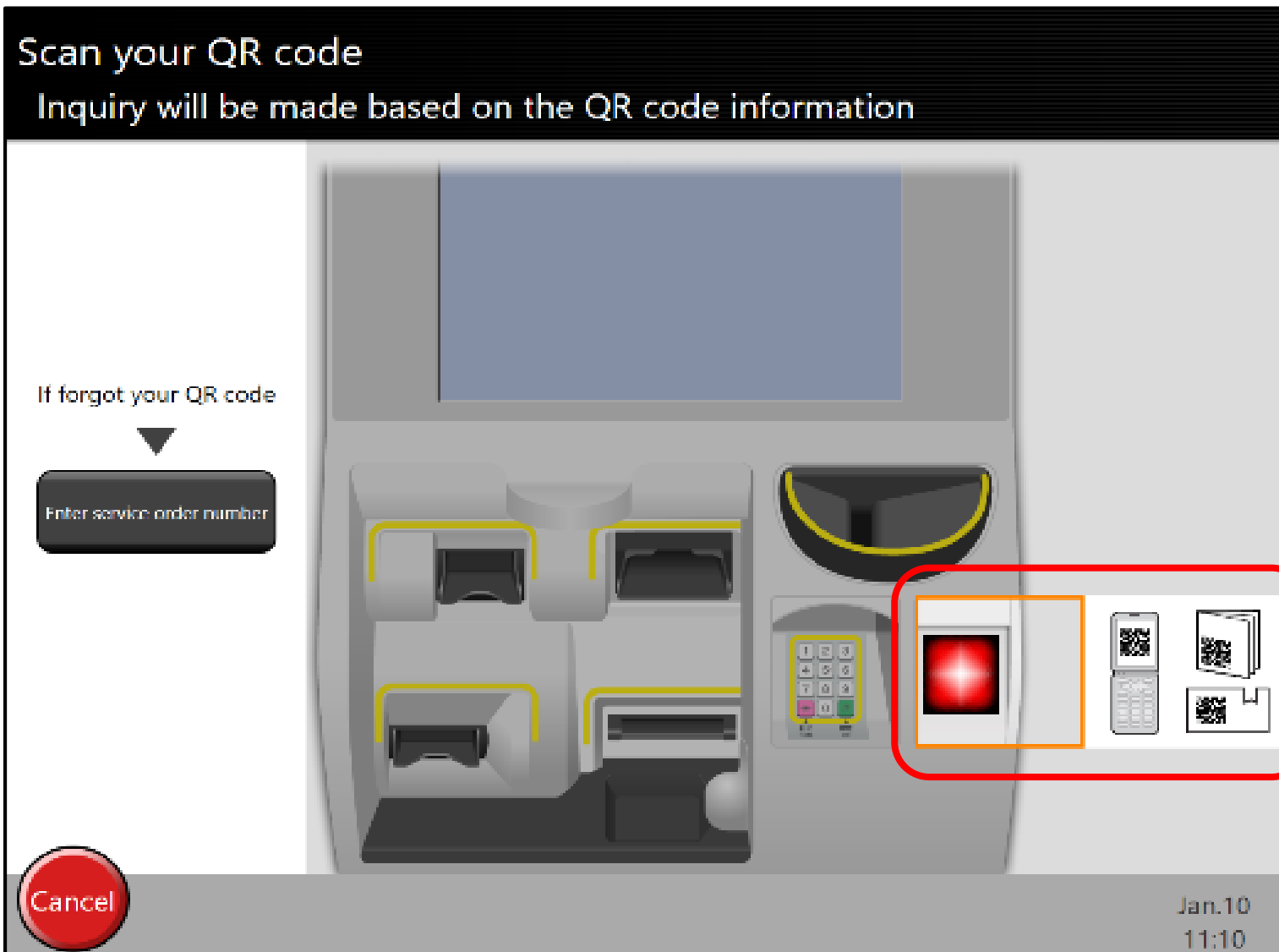

④ 시작일

최대 1개월 후 날짜까지 선택 가능

Select the start date

	Sun.	Mon.	Tues.	Wed.	Thurs.	Fri.	Sat.
Dec.						Today	26
	27	28	29	30	31		
Jan.						1	2
	3	4	5	6	7	8	9
	10	11	12	13	14	15	16
	17	18	19	20	21	22	23
	24	next month 25					

Cancel

Nov.20
19:12

⑤ 자격(임시 방문) 및 개인정보에 대한 동의

외국 여권 소지자
+
임시 방문자

Please confirm

Confirm the following conditions before exchanging MCO(E-TICKET)

MCO(E-TICKET) can only be exchanged for visitors to Japan.
To exchange, you need to meet the following two conditions.

- Holding a passport issued by a country other than Japan.
- Having entered Japan with a Temporary Visitor entry status.

Note that you will not be able to use a MCO(E-TICKET) if you do not meet the conditions above.

If you meet the conditions above, press Confirm.

Confirm

Cancel

Please confirm

Purposes for collecting personal information

Personal information collected will be used for the following purposes.

- Receiving tickets reserved
- Confirming your identity when exchanging MCO(E-TICKET)

West Japan Railway Company

If you agree to the terms above, press Agree.

Agree

Cancel

Jan.10
14:20

개인정보에 대한
동의

⑥ 여권 스캔

※ 전자여권만 해당

Scan your passport

Place the photo page of your passport on the reader



Cancel

Nov.20
17:53

⑦ 확인 페이지

If OK, press Confirm

Service order number	MNN123456789012
Ticket type	간사이 와이드 패스
Validity period	6월 15일 ~ 6월 19일

If OK ▶

Confirm

Cancel

Jan.10
11:23

레일 패스 발급하기

자동 개찰구 사용가능!





NISSAN TRAVEL AGENCY CO., LTD.

JAPAN RAIL PASS 14DAY

Number (Order No.) : 50401000633
The number cannot be used for re-issuing.

ISSUE TERMS
 Issue : 01 May 2016 (JTR/ADULT)
 Issue Period : ADULT

No. : 0001 (Japan Railway Company)
 JPN : 0000
 JPN/Company : 0000
 JTR/JPN/Company : 0000
 Issue No. : JTR 0000 10000 140000 0000

Issue Date : 01 Apr 2016 Settings (URL) is 1 month from the issuance.



① Issuance : Issued under the following conditions. It being issued subject to the railway company for "Issuance under" terms and conditions stipulated, and it may be re-issued in the form of this railway pass. The railway company shall not be liable for the validity of the railway pass issued under the conditions.

② Issuance : Issuance is subject to the railway company's approval. It being issued subject to the railway company for "Issuance under" terms and conditions stipulated, and it may be re-issued in the form of this railway pass. The railway company shall not be liable for the validity of the railway pass issued under the conditions.

③ Issuance : Issuance is subject to the railway company's approval. It being issued subject to the railway company for "Issuance under" terms and conditions stipulated, and it may be re-issued in the form of this railway pass. The railway company shall not be liable for the validity of the railway pass issued under the conditions.

④ Issuance : Issuance is subject to the railway company's approval. It being issued subject to the railway company for "Issuance under" terms and conditions stipulated, and it may be re-issued in the form of this railway pass. The railway company shall not be liable for the validity of the railway pass issued under the conditions.

NISSAN TRAVEL AGENCY CO., LTD. (010) 3380-1111 (03) 5561-1111

ISSUE NO. (010) 3380-1111 (03) 5561-1111		ISSUE NO. (010) 3380-1111 (03) 5561-1111	
ISSUE NO. (010) 3380-1111 (03) 5561-1111	ISSUE NO. (010) 3380-1111 (03) 5561-1111	ISSUE NO. (010) 3380-1111 (03) 5561-1111	ISSUE NO. (010) 3380-1111 (03) 5561-1111
ISSUE NO. (010) 3380-1111 (03) 5561-1111	ISSUE NO. (010) 3380-1111 (03) 5561-1111	ISSUE NO. (010) 3380-1111 (03) 5561-1111	ISSUE NO. (010) 3380-1111 (03) 5561-1111